



OPTIMIZED PERFORMANCE FOR CONVEYOR SYSTEMS

A detailed close-up photograph of a RUD FORKLY conveyor component. It features a central silver-colored metal fork with two large, white, cylindrical rollers. This fork is connected to two thick, orange-painted metal arms. The word "RUD" is embossed on the metal fork and printed on the orange arms. The background is dark and out of focus.

**FORKLY**

Improve efficiency and perfection in planning,  
running costs and maintenance

# RUD SYSTEMS FOR CONVEYORS – CONVINCING QUALITY AND RELIABILITY



RUD conveyor systems offer optimum solutions for the bulk materials handling industries.

We design and manufacture bucket elevators and trough-chain conveyors for bulk materials, with round steel chains, FORKED CHAINS and belts as traction mechanisms.

## ADVANTAGE NO 1: REDUCED WEIGHT.

We focus on your costs!

We developed our new RUD FORKED CHAINS with a ten percent target weight reduction. This would enable you to use smaller drives and reduce your energy costs.

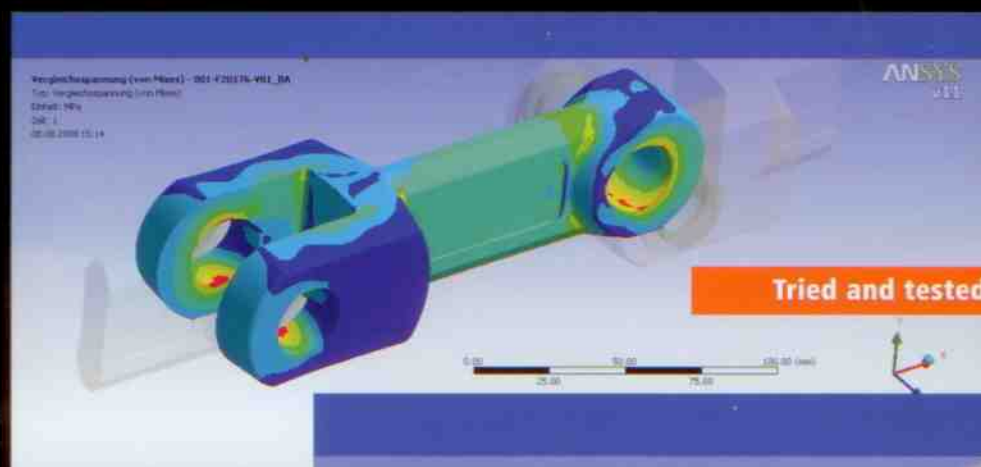

Tried and tested: RUD forked chains

# FORKY



Optimized for higher performance: RUD FORKY

We used state-of-the-art technology of calculation to achieve our targets.

We have reduced the absolute stresses in the notch-sensitive areas, and evened out the distribution of the cross-sectional stresses.

## ADVANTAGE NO 2:

### SOPHISTICATED WEAR INDICATOR

A sophisticated, visible wear indicator gives you an overview of the amount of wear in your system at a glance.

This makes breakdowns and unscheduled interruptions things of the past.

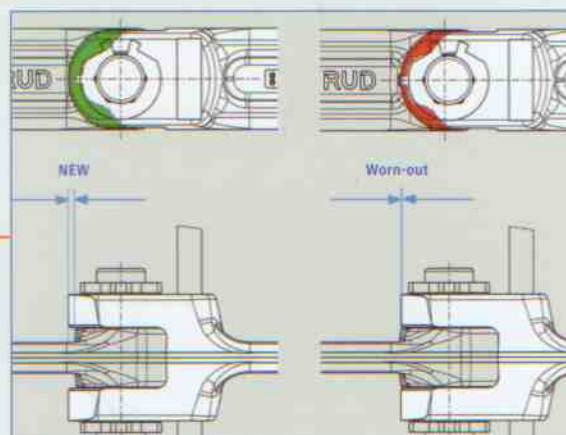

#### Deburred holes

- Even on the inner sides of the forks, for the highest long-term strength and reliability

#### Visible wear indicator

- The amount of wear on each individual chain link can be seen at a glance.

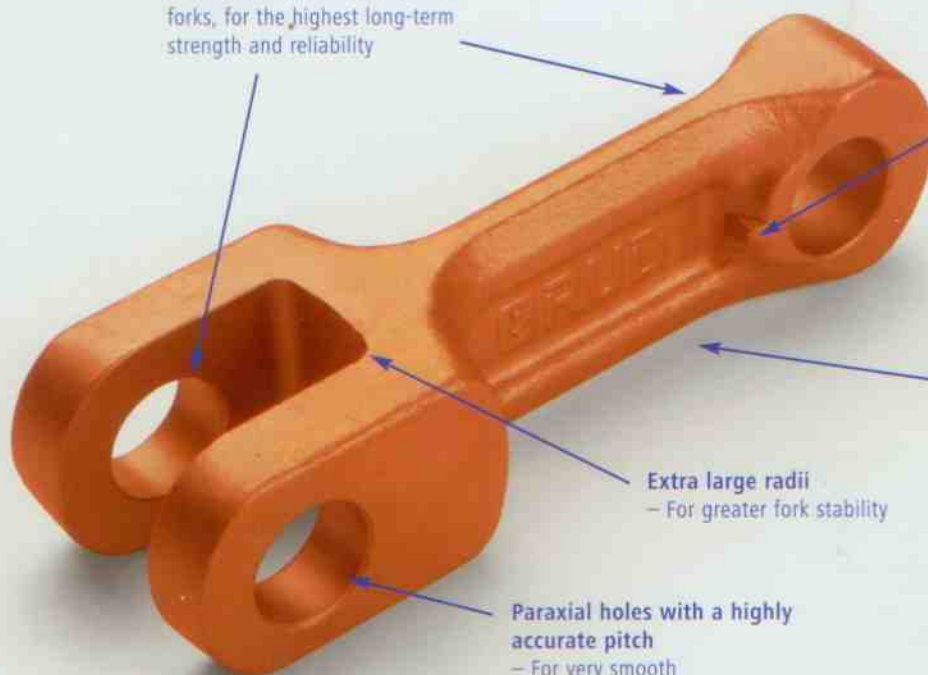

#### Stress-optimized link design

- For optimal grain flow orientation and highest lateral rigidity

#### Extra large radii

- For greater fork stability

#### Paraxial holes with a highly accurate pitch

- For very smooth running and, consequently
- Minimal wear

## ADVANTAGE NO 3:

### HIGHEST STRENGTH AND DURABILITY IN USE

RUD FORKY FORKED CHAINS impress with the outstanding qualities and properties of their material. Drop-forged alloyed steel ensures the highest strength and long-term durability and so guaranteeing performance. The unique RUD heat-treatment process guarantees a constant material quality, and so high system availability. The forked chains are top-quality forged under optimal design of the grain flow orientation in the die.



## YOUR ADVANTAGES AT A GLANCE...

### Reduced weight

YOU SAVE ON ENERGY COSTS AND  
REDUCE CO<sub>2</sub>-EMISSIONS !

### Sophisticated wear indicator

ALLOWS BETTER PLANNING OF MAINTENANCE!

### Highest strength and durability in use

YOU SAVE THROUGH LONG PERIODS OF USE!



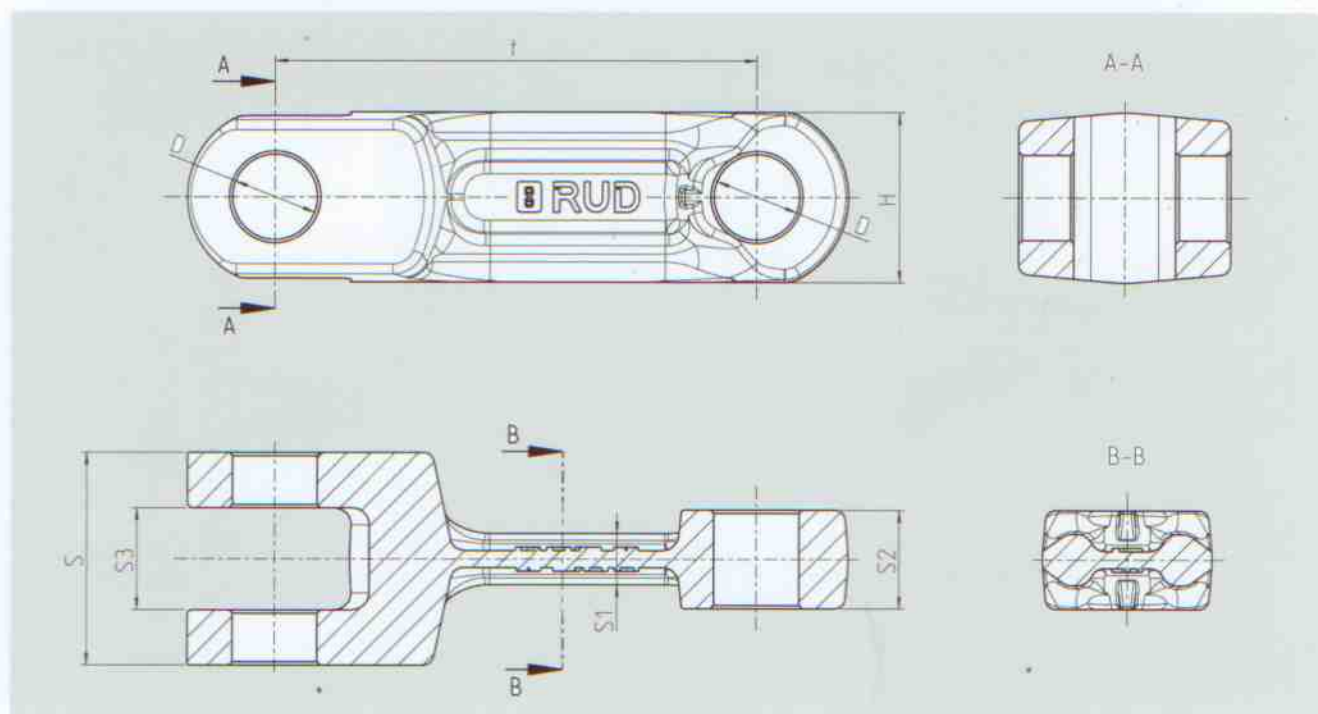

Size	Breaking force (kN)	t (mm)	D (mm)	S (mm)	S1 (mm)	S2 (mm)	S3 (mm)	H (mm)
102x36x13	170	101,6	14	30	8	13	14	36
142x50x19	300	142	25	42	13	19	20	50
142x50x29	480	142	25	62,5	15	29	30	50
260x75x31	700	260	32	70	20	31	32	75

# RUD FORKY



Scrapers for use in single-strand conveyors

Model T (square profile) or BT (right angular profile) Model U

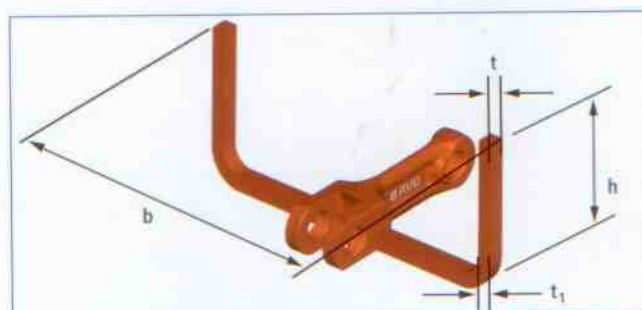
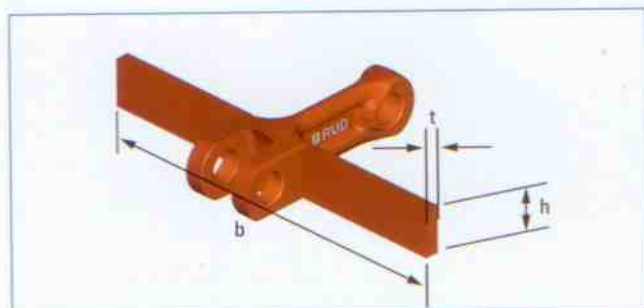

Model	b (mm)	h (mm)	t (mm)	t <sub>1</sub> (mm)	Comments
BT	200 - 400 (500)	50	10 - 15	---	Other designs available on request.
T	200 - 400 (500)	20 - 25	20 - 25	---	
U	200 - 400 (500)	200 - 300	10 - 15	max. 25	

Can be manufactured to customer request (sample or drawing required)

## Multipart construction

The sprocket wheels are manufactured of C45. The flanks of the teeth are induction hardened. The sprocket elements on the fitted hubs are exchangeable.

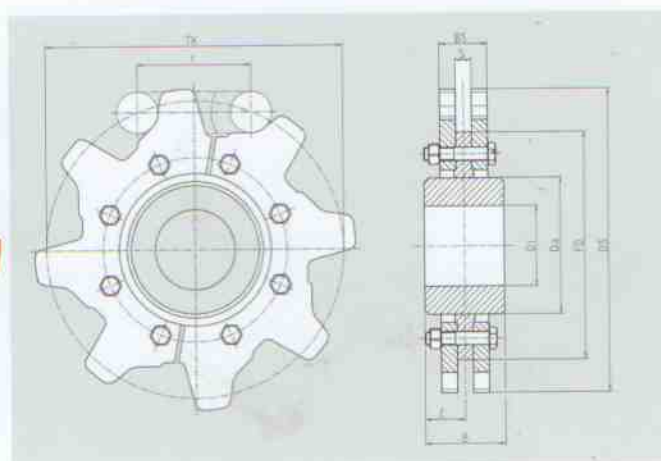

Pitch	Teeth	TK (mm)	BS (mm)	S (mm)	Da (mm)	Di max (mm)	Di roh (mm)	B (mm)	C (mm)	FD (mm)	DS (mm)
102x36x13	7	235,1	31	9	120	85	30	80	40	170	252
	8	266,5			140	100		90	45	195	285
142x50x19 142x50x29	8	371	42 63	15 17	180	120	30	120	60	285	401
	10	460	42 63	15 17	270	165	30	160	80	378	495
260x75x31	8	679,4	80	23	340	240	50	180	90	560	725
	10	841,4			380	255		220	110	715	885

Other materials and designs available on request.



## One-piece model

Guide wheels manufactured of C45.

The contact surface is induction hardened.

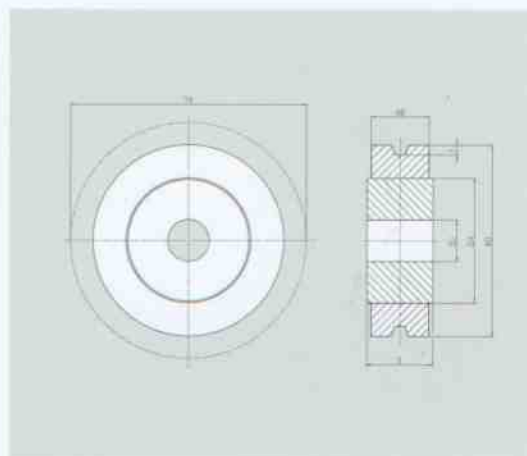

Teilung	Zähne	TK (mm)	AD (mm)	AB (mm)	T (mm)	Da (mm)	Di roh (mm)	B (mm)
102x36x13	$\frac{7}{8}$	$\frac{235,1}{266,5}$	$\frac{191}{230}$	40	10	$\frac{170}{200}$	30	45
142x50x19 142x50x29	8	371	320	$\frac{50}{70}$	12	250	30	$\frac{60}{80}$
142x50x19 142x50x29	10	460	410	$\frac{50}{70}$	12	350	30	$\frac{60}{80}$
260x75x31	$\frac{8}{10}$	$\frac{679,4}{841,4}$	$\frac{605}{765}$	80	12	$\frac{500}{550}$	50	90

Other materials and designs available on request.

## Our Capabilities

- Consultancy and planning
- Project management
- Design
- Manufacturing
- Installation
- Service

## For market segments

- Mining/power generation
- Iron and steel works
- Tunnel construction
- Quarrying
- Chemical Industry
- Recycling
- Cement Industry





Tradition in Leadership

RUD Ketten  
Rieger & Dietz GmbH u. Co. KG  
Friedensinsel  
73432 Aalen/Germany  
Telephone +49 7361 504-0  
Fax +49 7361 504-1523  
rudketten@rud.com  
www.rud.com

A close-up photograph of a red metal chain link, likely a part of a forklift. The link is thick and robust, with a visible pin and bushing. The word 'RUD' is embossed on the side of the link.

# FORKY

RUD worldwide communication and  
sales network